

**BEDALE COMMUNITY LIBRARY**  
**ANNUAL REPORT**  
**1 APRIL 2025 – 31 MARCH 2026**



And it's not all been about books!

Bedale Community Library has had another successful year so we wanted to share that success with the users of our services, our wonderful volunteers and the wider public. We hope you enjoy reading this report.

**Jenny Barrie, Chair of Bedale Community Library**

Over the last year, Bedale Community Library had nearly **20,000 visits** and issued over **90,000 books**. The population of the library's catchment area is just over **13,000** giving ratios of about 1.5 visits / head and nearly 7.0 issues / head.

**Bedale Community Library is run by volunteers** and we always need new volunteers to welcome, advise and assist library users. New volunteers are trained and supported by the North Yorkshire Libraries Service and experienced volunteers. Most volunteers undertake up to three, three hour shifts in the library each month, working in pairs. The rota is compiled around each individual's availability. For more information visit the library, email [committee@bedalecommunitylibrary.org.uk](mailto:committee@bedalecommunitylibrary.org.uk) or go to

<https://www.bedalecommunitylibrary.org.uk/volunteer-in-the-library>

We are grateful, as ever, to the **Friends of Bedale Community Library** for their support both financial and otherwise. Friends have already contributed over £1000 again in 2026 and, as the vast majority of donations are eligible for Gift Aid, we will be able to claim a further 25% from HMRC. This is a very significant contribution to the annual running costs of our library.

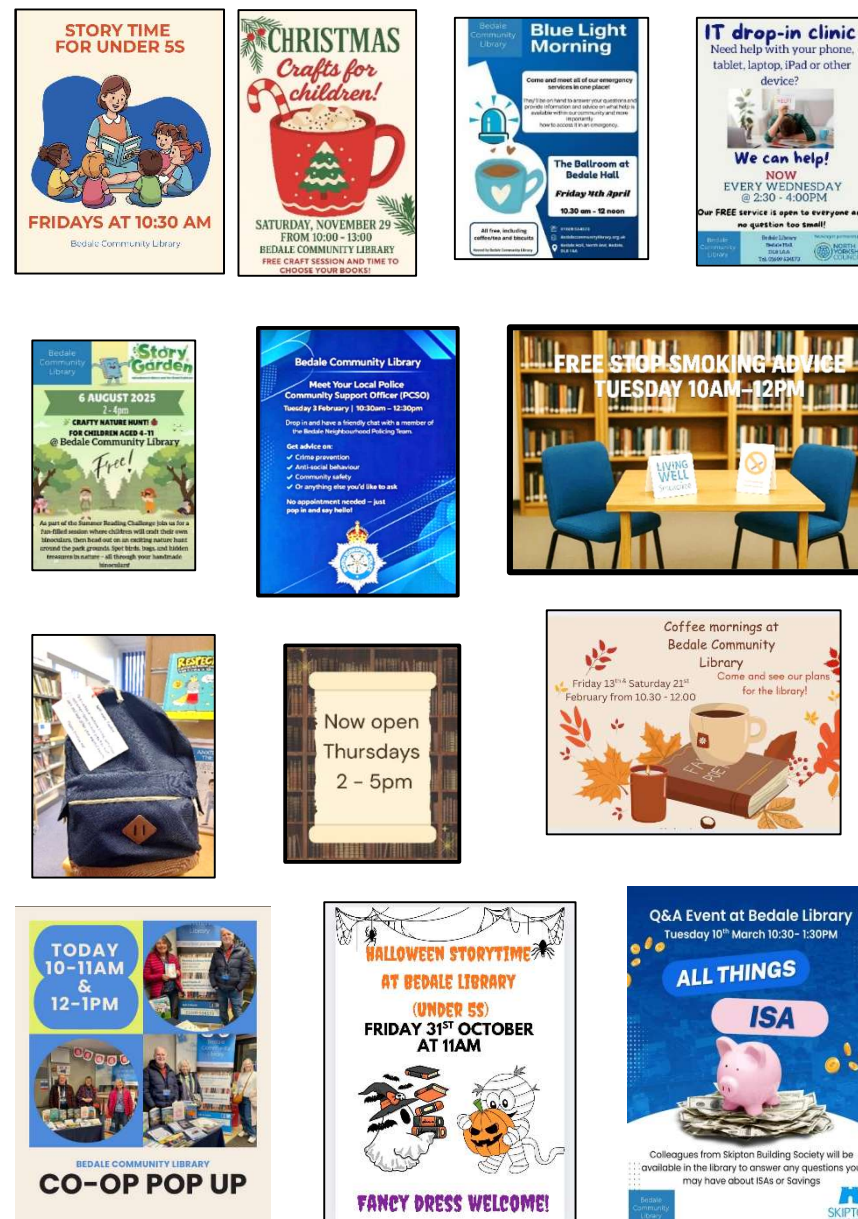

## Accounts 2025 / 26

Despite the cancellation of our major fund-raising event, Bedale Car Boot sale, because of heavy rain, 2025/26 has been a good year financially for BCL with receipts exceeding payments. Balances remain strong, well in excess of the Trustees target of at least one year's expenditure. The credit / debit card facility introduced last year now accounts for around half of the value of all receipts.

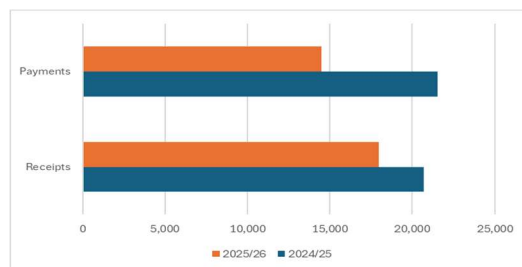

Improvements this year have included two new heaters, (courtesy of

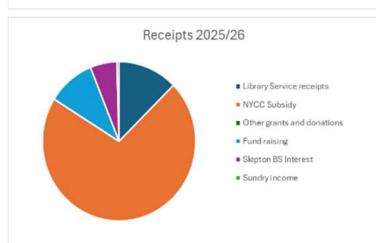
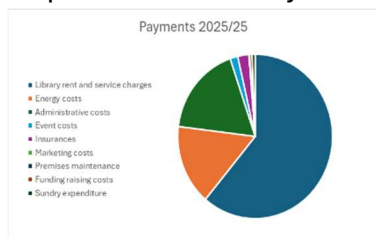

Bedale Hall Trustees), new signposts in all three locations and a new A-board. We anticipate major expenditure in 2026/27 as we progress the plans for refurbishment and further improvement of our facilities. We are grateful to the National Lottery (£20000), Bedale 4&20 (£9228.15), Skipton Building Society (£600) and North Yorkshire Council's Inspire Fund (£1000) for financial support but, as these funds are earmarked to be put towards the refurbishment and

improvement and in order to provide better year on year comparisons, they have not been included in these charts.

As ever, we must express our thanks for the high level of support from North Yorkshire Council's Library Service both financially and professionally.

In January 2026, we published **exciting and ambitious plans to refurbish and revitalise the library**. The package of proposals includes redecoration and new carpets throughout, restructuring the internal layout of the library to include new children's and reception areas and updating the kitchen / resource room. **The whole package will cost around £34000** and following successful applications for financial support to a number of organisations, as identified on the previous page, we are ready to proceed. The image below gives some idea of the plans:

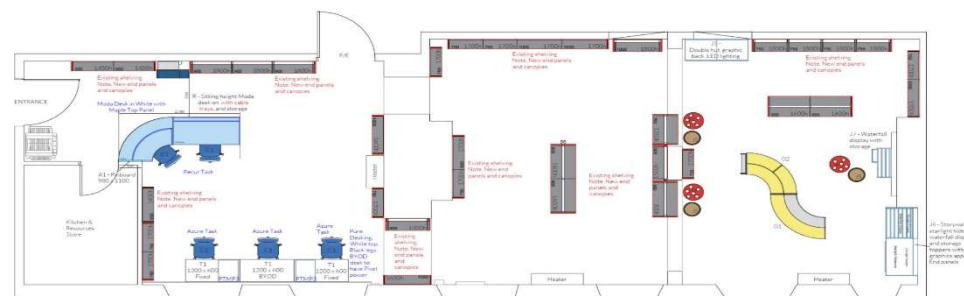

Based on national comparators, we anticipate that visits and issues will increase by at least 10% and possibly up to 30% following the refurbishment.

## Trustees

This year saw the departure of another long-standing Trustee, **Andy Hallett**. Andy served the library with great dedication and energy for many years not least as Chairman so we thank him very much. As at 31 March 2026 we have six Trustees: Jenny Barrie, Chris McGee, Chris Chipp, Carol D'Andrade, Elaine Averis and Jade Gill. We are always on the lookout for new Trustees so, if anyone is interested, please contact us on [library@bedalecommunitylibrary.org.uk](mailto:library@bedalecommunitylibrary.org.uk)